

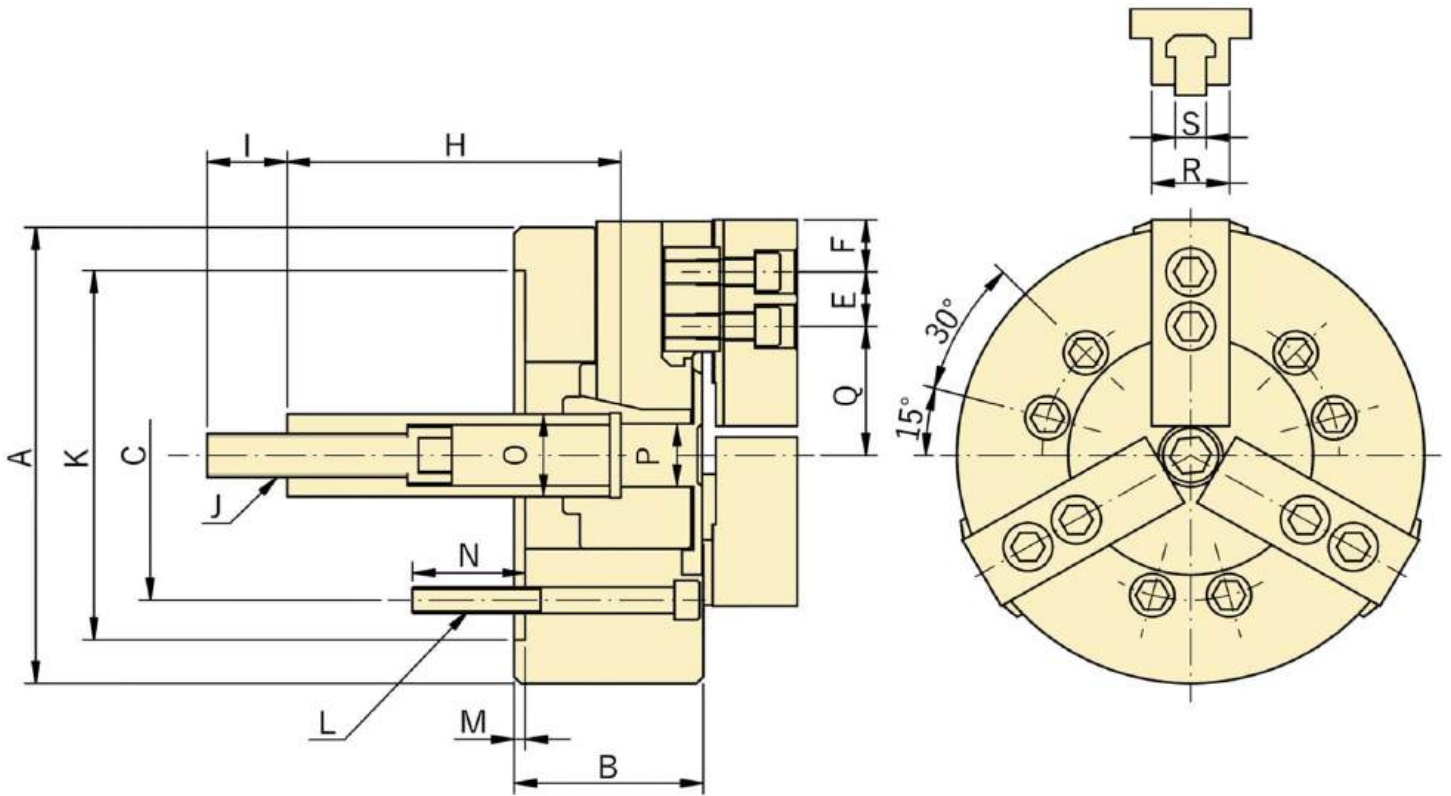

V- SERIES

三爪中實油壓夾頭(不含連接板)

3-JAW WEDGE TYPE NON THROUGH HOLE POWER CHUCK
(without ADAPTOR)



SPECIFICATION

MODEL	爪行程 (直徑) Jaw Stroke (Dia.) (mm)	柱塞行程 Plunger Stroke (mm)	把握徑 Clamping Dia.		最高轉數 Max. Rotation Speed (r.p.m.)	最大拉桿推力 Max. Draw Bar Pull Force (kgf)	把握力 Max. Clamping Force (kgf) / (kgf/cm ²)	慣性矩 Moment of Inertia (kg·m ²)	重量 Weight (KG)	搭配油壓缸 Matching Hydraulic Cylinder	搭配硬爪 Matching Hard Jaw	搭配生爪 Matching Soft Jaw
			Max. (mm)	Min. (mm)								
V-206	8.5	20	165	12	5000	1835	5253 / 25.5	0.045	12	MH-105	HJ-06	HC-06
V-208	8.8	21	210	12	4000	2549	7548 / 24.5	0.137	22.8	MH-125	HJ-08	HC-08
V-210	8.8	25	254	16	3500	2957	11013 / 28.6	0.3	34.4	MH-125	HJ-10	HC-10
V-212	10.5	30	304	18	3000	4181	15807 / 27.5	0.725	59	MH-150	HJ-12-1	HC-12-1
V-215	16	35	381	68	2800	8362	25391 / 32.6	1.8	100.6	MH-200	HJ-15-1	HC-15-1
V-218	16	35	450	40	2700	8362	25391 / 32.6	2.35	126	MS-200	HJ-15-1	HC-15-1
V-221	16	35	530	50	1900	8362	25391 / 32.6	4.8	187	MS-200	HJ-21-1	HC-21-1
V-224	16	35	610	50	1750	8362	25391 / 32.6	6.92	225	MS-200	HJ-21-1	HC-21-1

DIMENSION

MODEL	A	B	KH6	M	C	P	L	N	F	Q		E		H		S	R	J	O	I
										Max.	Min.	Max.	Min.	Max.	Min.					
V-206	165	74	140	5	104.78	21	6-M10	14	20	37.8	33.55	18	7.5	104.6	84.6	12	31	M16x2.0	34	36
V-208	210	85	170	5	133.35	25	6-M12	20	25	46.3	41.9	22.5	9	132	111	14	35	M20x2.5	38	36
V-210	254	89	220	5	171.45	34	6-M16	18	30	51.1	46.7	37.5	10.5	158	133	16	40	M20x2.5	45	36
V-212	304	106	220	6	171.45	34	6-M16	22	30	61	55.75	47	11	163	133	18	50	M20x2.5	50	36
V-215	382	114	300	6	235	-	6-M20	29	43	77.5	69.5	50.25	23.25	104	69	25.5	50	M30x3.5	60	55
V-218	450	114	300	6	235	-	6-M20	29	43	108	100	93	24	92	57	25.5	50	M30x3.5	60	55
V-221	530	125	380	6	330.2	-	6-M24	31	60	86.5	78.5	93	24	97	62	25	65	M30x3.5	60	55
V-224	610	125	380	6	330.2	-	6-M24	31	60	125	117	93	24	97	62	25	65	M30x3.5	60	55



VA- SERIES

三爪中實油壓夾頭(包含連接板)

3-JAW WEDGE TYPE NON THROUGH HOLE POWER CHUCK (with ADAPTOR)

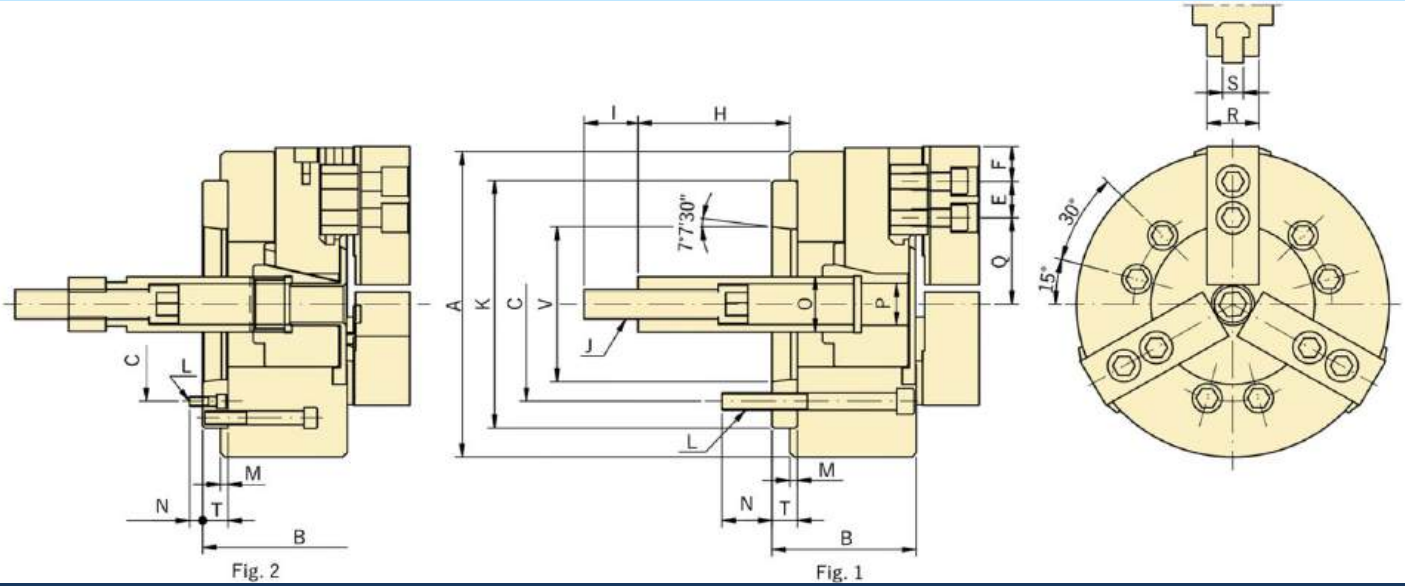

SPECIFICATION

MODEL	爪行程 (直徑) Jaw Stroke (Dia.) (mm)	柱塞行程 Plunger Stroke (mm)	把握徑 Clamping Dia.		最高轉數 Max. Rotation Speed (r.p.m.)	最大拉桿推力 Max. Draw Bar Pull Force (kgf)	把握力 Max. Clamping Force (kgf) / (kgf/cm ²)	慣性矩 Moment of Inertia (kg-m ²)	重量 Weight (KG)	搭配油壓缸 Matching Hydraulic Cylinder	搭配硬爪 Matching Hard Jaw	搭配生爪 Matching Soft Jaw
			Max. (mm)	Min. (mm)								
V-206A5	8.5	20	165	12	5270	1835	5253 / 25.5	0.045	12.5	MH-105	HJ-06	HC-06
V-208A5	8.8	21	210	12	4765	2549	7548 / 24.5	0.142	27.3	MH-125	HJ-08	HC-08
V-208A6	8.8	21	210	12	4765	2549	7548 / 24.5	0.137	24.4	MH-125	HJ-08	HC-08
V-210A6	8.8	25	254	16	4010	2957	10013 / 28.6	0.3	40.65	MH-125	HJ-10	HC-10
V-210A8	8.8	25	254	16	4010	2957	10013 / 28.6	0.3	37.15	MH-125	HJ-10	HC-10
V-212A8	10.5	30	304	18	3380	4181	15807 / 27.5	0.725	61.75	MH-150	HJ-12-1	HC-12-1
V-215A8	16	35	381	68	3000	8362	25391 / 30.6	1.8	105	MH-150	HJ-15-1	HC-15-1
V-215A11	16	35	381	68	3000	8362	25391 / 32.6	1.8	103	MH-200	HJ-15-1	HC-15-1
V-218A8	16	35	450	40	2700	8362	25391 / 32.6	2.41	134	MS-200	HJ-15-1	HC-15-1
V-218A11	16	35	450	40	2700	8362	25391 / 32.6	2.11	123	MS-200	HJ-15-1	HC-15-1
V-221A11	16	35	530	50	1900	8362	25391 / 32.6	5.1	193	MS-200	HJ-21-1	HC-21-1
V-221A15	16	35	530	50	1900	8362	25391 / 32.6	4.9	187	MS-200	HJ-21-1	HC-21-1
V-224A11	16	35	610	50	1750	8362	25391 / 32.6	7.5	239	MS-200	HJ-21-1	HC-21-1
V-224A15	16	35	610	50	1750	8362	25391 / 32.6	7.1	233	MS-200	HJ-21-1	HC-21-1

DIMENSION

MODEL	A	B	C	F	K	L	M	N	P	T	V	E		H		I	J	O	Q		R	S	Ref. Fig.	
												Max.	Min.	Max.	Min.				Max.	Min.				
V-206A5	165	84	104.78	20	140	6-M10	5	14	21	15	82.563	18	7.5	4	89.6	69.6	36	M16x2.0	34	37.8	33.5	31	12	Fig. 1
V-208A5	210	103	104.78	25	170	6-M10	5	13	21	23	82.563	22.5	9	5	109	88	36	M20x2.5	38	46.3	41.9	35	14	Fig. 2
V-208A6	210	97	133.35	25	170	6-M12	5	18	25	17	106.375	22.5	9	5	115	94	36	M20x2.5	38	46.3	41.9	35	14	Fig. 1
V-210A6	254	109	133.35	30	220	6-M12	5	18	34	25	106.375	37.5	10.5	5	133	108	36	M20x2.5	45	51.1	46.7	40	16	Fig. 2
V-210A8	254	102	171.45	30	220	6-M16	5	25	34	18	139.719	37.5	10.5	5	140	115	36	M20x2.5	45	51.1	46.7	40	16	Fig. 1
V-212A8	304	118	171.45	30	220	6-M16	6	25	34	18	139.719	47	11	5	145	115	36	M20x2.5	50	61	55.75	50	18	Fig. 1
V-215A8	381	141	171.45	43	300	6-M16	6	24	-	33	139.719	50.25	23.25	2	71	36	55	M30x3.5	60	77.5	69.5	50	25.5	Fig. 2
V-215A11	381	130	235	43	300	6-M20	6	32	-	22	196.869	50.25	23.25	2	82	47	55	M30x3.5	60	77.5	69.5	50	25.5	Fig. 1
V-218A8	450	141	171.45	43	300	6-M20	6	24	-	33	139.719	50.25	23.25	3	59	24	55	M30x3.5	60	108	100	50	25.5	Fig. 2
V-218A11	450	130	235	43	300	6-M20	6	32	-	22	196.869	50.25	23.25	3	70	35	55	M30x3.5	60	108	100	50	25.5	Fig. 1
V-221A11	530	146	235	60	380	6-M20	6	28	-	27	196.869	93.5	24.5	3	70	35	55	M30x3.5	60	86	78	65	25	Fig. 1
V-221A15	530	146	330.2	60	380	6-M24	6	34	-	27	285.75	93.5	24.5	3	70	35	55	M30x3.5	60	86	78	65	25	Fig. 1
V-224A11	610	146	235	60	380	6-M20	6	28	-	27	196.869	93.5	24.5	3	70	35	55	M30x3.5	60	125	117	65	25	Fig. 2
V-224A15	610	146	330.2	60	380	6-M24	6	34	-	27	285.75	93.5	24.5	3	70	35	55	M30x3.5	60	125	117	65	25	Fig. 1



VT- SERIES

Tomfau

兩爪中實油壓夾頭(不含連接板)

2-JAW WEDGE TYPE NON THROUGH HOLE POWER CHUCK
(without ADAPTOR)

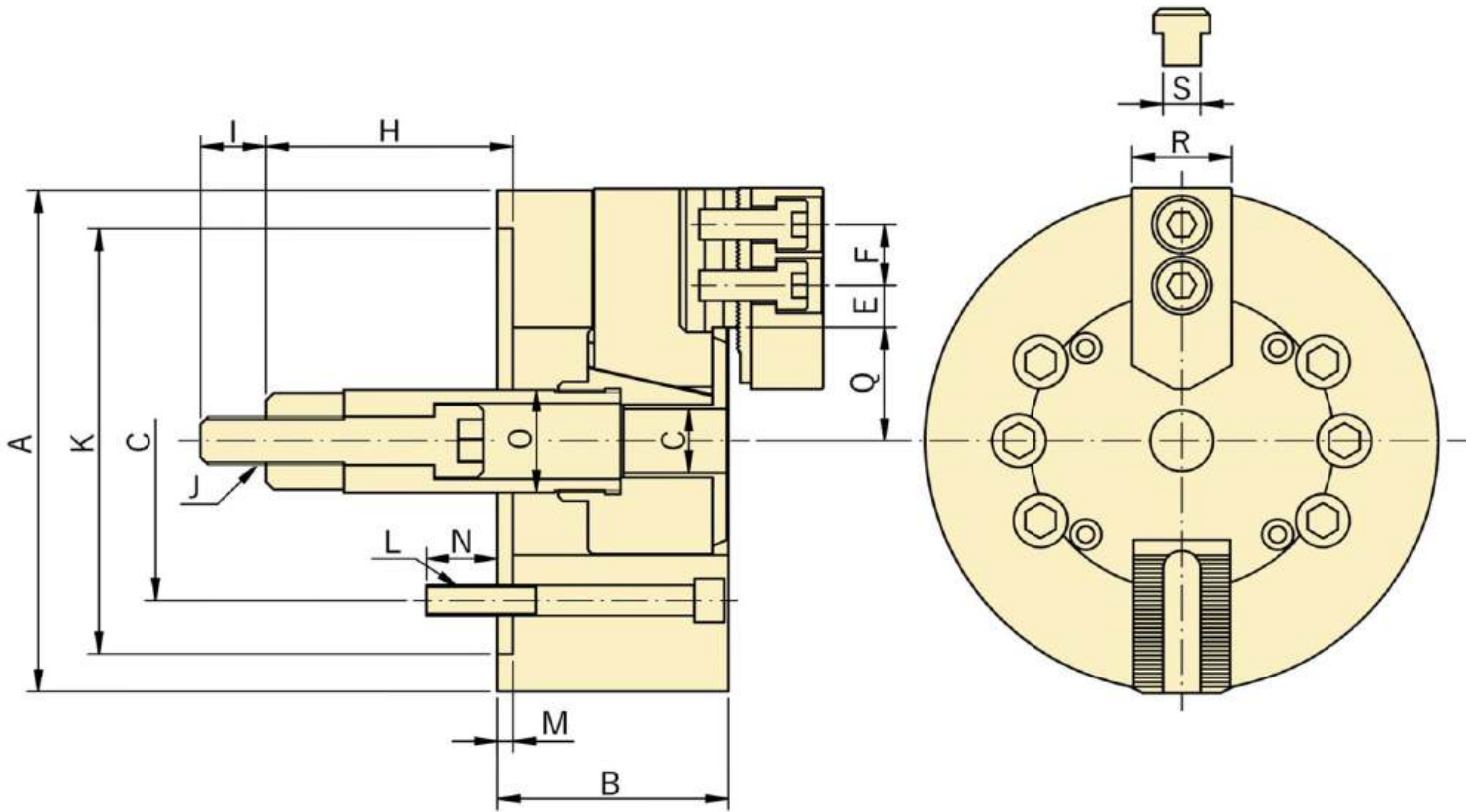

SPECIFICATION

MODEL	爪行程 (直徑) Jaw Stroke (Dia.) (mm)	柱塞行程 Plunger Stroke (mm)	把握徑 Clamping Dia.		最高轉數 Max. Rotation Speed (r.p.m.)	最大拉桿推力 Max. Draw Bar Pull Force kN	把握力 Max. Clamping Force kN	慣性矩 Moment of Inertia (kg·m ²)	重量 Weight (KG)	搭配油壓缸 Matching Hydraulic Cylinder	搭配硬爪 Matching Hard Jaw	搭配生爪 Matching Soft Jaw
			Max. (mm)	Min. (mm)								
VT-206	8.5	20	165	12	5100	1230	3500	0.04	12	MH-105	HJ-06	HC-06
VT-208	8.8	21	210	12	4650	1700	5100	0.13	22	MH-125	HJ-08	HC-08
VT-210	8.8	25	254	16	3810	2000	7250	0.29	33	MH-125	HJ-10	HC-10
VT-212	10.5	30	304	18	3200	2800	10500	0.7	57.3	MH-150	HJ-12-1	HC-12-1
VT-215	16	35	381	68	2800	5600	17000	1.7	96	MH-200	HJ-15-1	HC-15-1

DIMENSION

MODEL	A	B	C	E		F	H		I	J	K H6	L	M	N	O	P	Q		R	S
				Max.	Min.		Max.	Min.									Max.	Min.		
VT-206	165	74	104.78	18	7.5	20	89.6	69.6	36	M16x2.0	140	6-M10	5	14	34	21	37.8	33.5	31	12
VT-208	210	85	133.35	22.5	9	25	109	88	36	M20x2.5	170	6-M12	5	20	38	25	46.3	41.9	35	14
VT-210	254	89	171.45	37.5	10.5	30	140	115	36	M20x2.5	220	6-M16	5	18	45	34	51.1	46.7	40	16
VT-212	304	106	171.45	47	11	30	145	115	36	M20x2.5	220	6-M16	6	22	50	34	61	55.75	50	18
VT-215	381	114	235	50.25	23.25	43	71	36	55	M30x3.5	300	6-M20	6	29	60	-	77.5	69.5	50	25.5

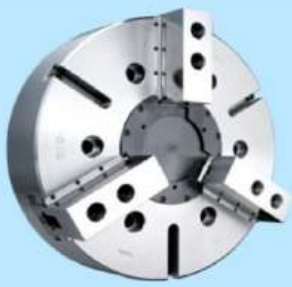

VWA- SERIES



三爪中實油防水壓夾頭(包含連接板)

3-JAW WEDGE TYPE NON THROUGH HOLE
WATERPROOF POWER CHUCK(with ADAPTOR)

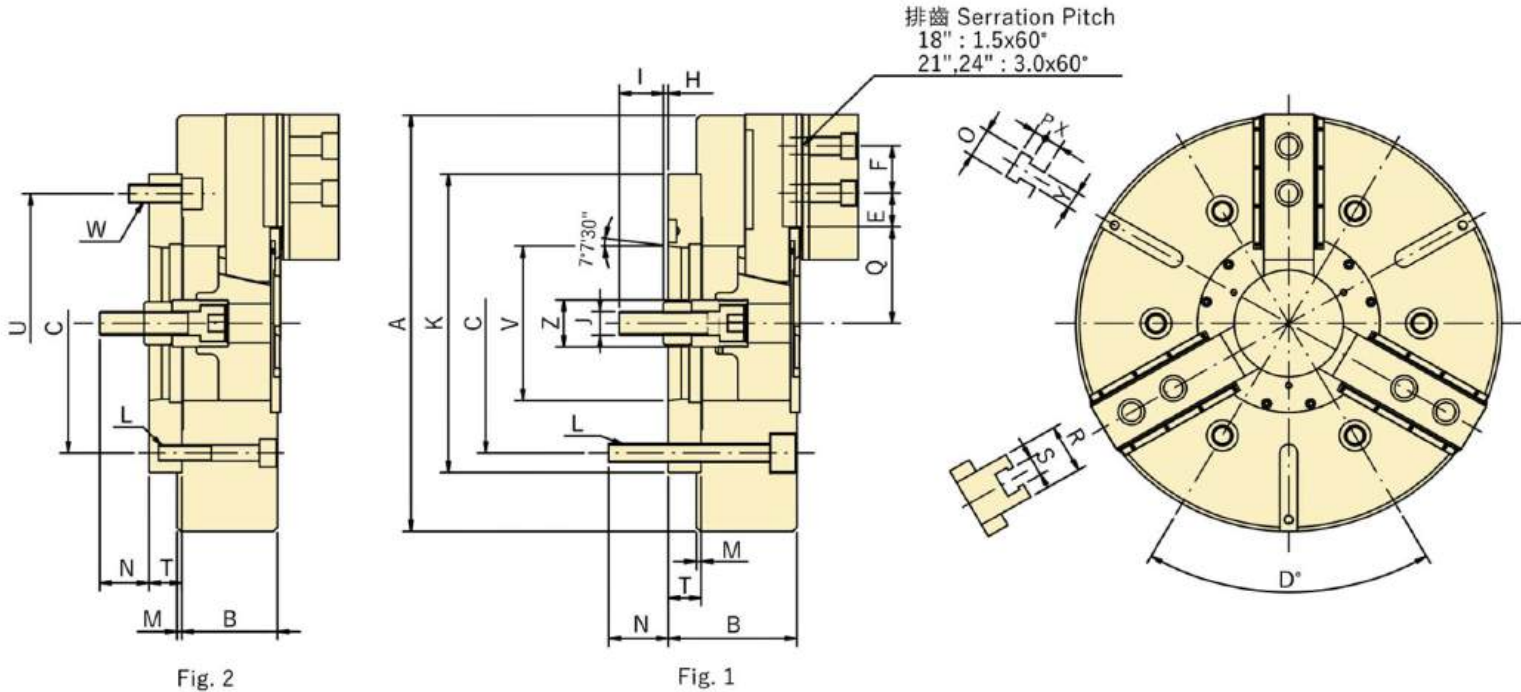

SPECIFICATION												
MODEL	爪行程(直徑) Jaw Stroke (Dia.) (mm)	柱塞行程 Plunger Stroke (mm)	把握徑 Clamping Dia.		最高轉數 Max. Rotation Speed (r.p.m.)	最大拉桿推力 Max. Draw Bar Pull Force (kgf)	把握力 Max. Clamping Force (kgf) / (kgf/cm ²)	慣性矩 Moment of Inertia (kg-m ²)	重量 Weight (KG)	搭配油壓缸 Matching Hydraulic Cylinder	搭配硬爪 Matching Hard Jaw	搭配生爪 Matching Soft Jaw
			Max. (mm)	Min. (mm)								
VW-218A8	16	35	450	40	2700	8362	25391 / 32.6	2.41	134	MS-200	HJ-15-1	HC-15-1
VW-218A11	16	35	450	40	2700	8362	25391 / 32.6	2.11	123	MS-200	HJ-15-1	HC-15-1
VW-221A11	16	35	530	50	1900	8362	25391 / 32.6	5.1	193	MS-200	HJ-21-1	HC-21-1
VW-221A15	16	35	530	50	1900	8362	25391 / 32.6	4.9	187	MS-200	HJ-21-1	HC-21-1
VW-224A11	16	35	610	50	1750	8362	25391 / 32.6	7.5	239	MS-200	HJ-21-1	HC-21-1
VW-224A15	16	35	610	50	1750	8362	25391 / 32.6	7.1	233	MS-200	HJ-21-1	HC-21-1

DIMENSION																									
MODEL	A	B	C	F	K	L	M	N	P	T	V	E		D	H		I	J	O	Q		R	S	Ref. Fig.	
												Max.	Min.		Max.	Min.				Max.	Min.				
VW-218A8	450	141	171.45	43	300	6-M16	6	24	22	33	139.719	50.25	23.25	30°	71	36	55	M30x3.5	37	108	100	50	25.5	Fig. 2	
VW-218A11	450	130	235	43	300	6-M20	6	22	22	22	196.869	50.25	23.25	30°	78	43	55	M30x3.5	37	108	100	50	25.5	Fig. 1	
VW-221A11	530	146	330.2	60	380	6-M20	6	24	22	27	196.869	93.5	24.5	60°	56	21	55	M30x3.5	37	86	78	65	25	Fig. 2	
VW-221A15	530	146	330.2	60	380	6-M24	6	34	22	27	285.75	93.5	24.5	60°	56	21	55	M30x3.5	37	86	78	65	25	Fig. 1	
VW-224A11	610	146	235	60	380	6-M20	6	28	22	27	196.869	93.5	24.5	60°	56	21	55	M30x3.5	37	125	117	65	25	Fig. 2	
VW-224A15	610	146	330.2	60	380	6-M24	6	34	22	27	285.75	93.5	24.5	60°	56	21	55	M30x3.5	37	125	117	65	25	Fig. 1	