

Tomfau[®]

PRODUCT CATALOG

POWER CHUCK



.HIGH PRECISION. .HIGH SPEED. .HIGH QUALITY.



TF3B- SERIES



三爪高速中空油壓夾頭(不包含連接板)

3-JAW HIGH SPEED WEDGE TYPE THROUGH HOLE POWER CHUCK
(without ADAPTOR)

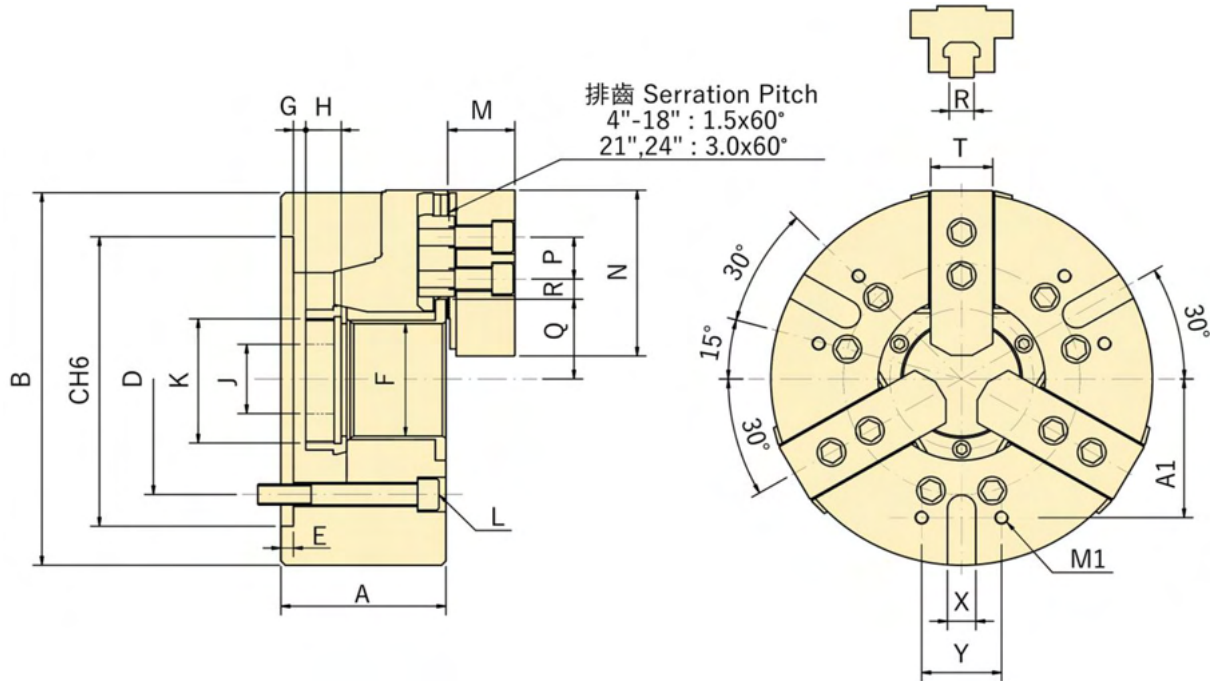

SPECIFICATION

MODEL	爪行程 (直徑) Jaw Stroke (Dia.) (mm)	柱塞行程 Plunger Stroke (mm)	把握徑 Clamping Dia.		最高轉數 Max. Rotation Speed (r.p.m.)	最大拉桿推力 Max. Draw Bar Pull Force kN(kgf)	把握力 Max. Clamping Force kN(kgf)	慣性矩 Moment of Inertia (kg·m ²)	重量 Weight (KG)	搭配油壓缸 Matching Hydraulic Cylinder	最高使用壓力 Max. Pressure of Hydraulic Cylinder (kgf/cm ²)
			Max. (mm)	Min. (mm)							
TF3B-4	5.4	10	110	5	8000	14 (1428)	28.5 (2906)	0.007	4	RC-4	24.5
TF3B-5	5.4	10	135	10	7000	17.5 (1784)	36 (3671)	0.018	6.7	RC-5	29.5
TF3B-6	5.5	12	165	10	6000	22 (2243)	57 (5812)	0.057	12.5	RC-6	28.5
TF3B-8	7.4	16	210	12	5000	34 (3467)	86 (8769)	0.167	22.6	RC-8	27
TF3B-10	8.8	19	254	16	4200	43 (4385)	111 (11319)	0.315	37	RC-10	27.5
TF3B-12	10.6	23	304	38	3300	55 (5608)	144 (14686)	0.737	61	RC-12	27.5
TF3B-15	10.6	23	381	40	2600	71 (7240)	180 (18355)	2.273	120	RC-15	27.5
TF3B-18	10.6	23	450	40	2000	71 (7240)	180 (18355)	4.776	166	RC-15	23.5
TF3B-21	13	28	530	50	1700	90 (9177)	234 (23861)	9.25	229	RC-2816	33
TF3B-24	13	28	610	50	1400	90 (9177)	234 (23861)	16.85	287	RC-2816	33

DIMENSION

MODEL	A	B	CH6	D	E	F	G		H	J	KMax	L	M	N	P	Q		R		T	X	Y	A1	M1
							Max.	min.								Max.	min.	Max.	min.					
TF3B-4	59	110	85	70.6	4	26	3.5	-6.5	17.5	12	M32x1.5	3-M10x60	24	49.5	14	23	20.3	11.25	6.75	23	-	-	-	-
TF3B-5	60	135	110	82.55	4	33	1	-9	20	25	M40x1.5	3-M10x60	26	54	14	26.5	23.8	19.75	7.75	23	12	30	52	2-M6
TF3B-6	81	169	140	104.78	5	45	11	-1	19	35	M55x2	6-M10x80	29	66	20	32	29.25	22.75	9.25	32	16	36	65	2-M8
TF3B-8	91	210	170	133.35	5	52	14.5	-1.5	20.5	40	M60x2	6-M12x90	39	95	25	38.7	35	29.75	14.75	35	16	45	80	2-M8
TF3B-10	100	254	220	171.45	5	75	8.5	-10.5	25	50	M85x2	6-M16x100	43	110	30	51	46.6	33.75	14.25	40	16	60	102	2-M10
TF3B-12	110	304	220	171.45	6	91	8	-15	28	50	M100x2	6-M16x110	51	130	30	61.3	56	45.75	15.75	50	20	60	102	2-M10
TF3B-15	133	381	300	235	6	117.5	12	-11	39	50	M130x2	6-M20x150	66	165	43	70	64.7	54.75	20.25	50	20	80	150	2-M12
TF3B-18	133	450	300	235	6	117.5	12	-11	39	50	M130x2	6-M20x150	66	165	43	82	76.7	78.25	18.25	50	20	80	150	2-M12
TF3B-21	148	530	380	330.2	6	170	16	-12	40	50	M180x3	6-M24x140	74	185	60	108	101.5	117.5	21.5	62	20	100	200	2-M12
TF3B-24	148	610	380	330.2	6	170	16	-12	40	50	M180x3	6-M24x140	74	185	60	108	101.5	117.5	21.5	62	20	100	200	2-M12



TF3BA- SERIES



三爪高速中空油壓夾頭(包含連接板)

3-JAW HIGH SPEED WEDGE TYPE THROUGH HOLE POWER CHUCK (with ADAPTOR)

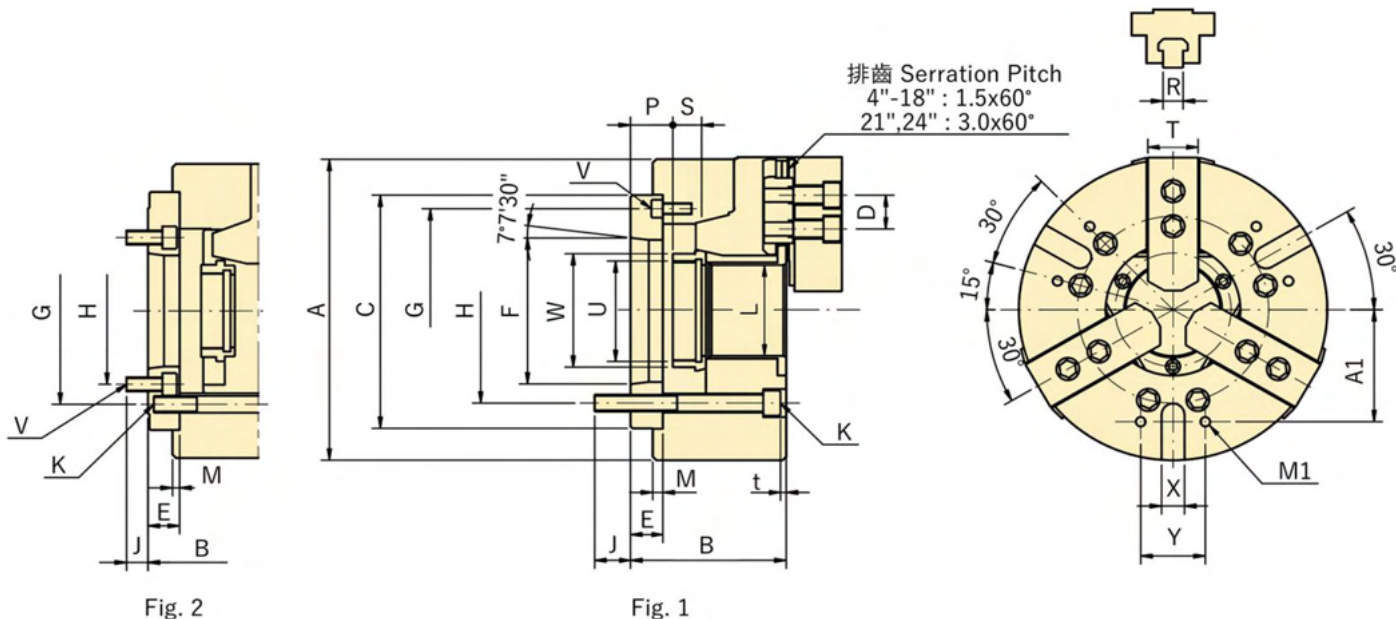

Fig. 2

Fig. 1

SPECIFICATION

MODEL	通孔徑 Through Hole Diameter (mm)	爪行程 (直徑) Jaw Stroke (Dia.) (mm)	柱塞行程 Plunger Stroke (mm)	把握徑 Clamping Dia.		最高轉數 Max. Rotation Speed (r.p.m.)	最大拉桿推力 Max. Draw Bar Pull Force (kgf)	把握力 Max. Clamping Force (kgf)	慣性矩 Moment of Inertia (kg·m ²)	重量 Weight (KG)	搭配油壓缸 Matching Hydraulic Cylinder	最高使用壓力 Max. Pressure of Hydraulic Cylinder (kgf/cm ²)	搭配生爪 Matching Soft Jaw	搭配硬爪 Matching Hard Jaw
				Max. (mm)	Min. (mm)									
TF3B-5A4	33	5.4	10	135	10	7000	1700	3600	0.020	6.9	RC-5	29.6	HC-05	HJ-05
TF3B-6A5	45	5.5	12	165	10	6000	2200	5700	0.062	14.2	RC-6	28.5	HC-06	HJ-06
TF3B-8A5	52	7.4	16	210	12	5000	3400	8800	0.190	25.8	RC-8	26.5	HC-08	HJ-08
TF3B-8A6	52	7.4	16	210	12	5000	3400	8800	0.184	24.05	RC-8	26.5	HC-08	HJ-08
TF3B-10A6	75	8.8	19	254	16	4200	4300	11000	0.370	40.9	RC-10	27.5	HC-10	HJ-10
TF3B-10A8	75	8.8	19	254	16	4200	4300	11000	0.340	37.4	RC-10	27.5	HC-10	HJ-10
TF3B-12A6	91	10.6	23	304	38	3300	5500	14300	0.809	61.5	RC-12	27.5	HC-12	HJ-12
TF3B-12A8	91	10.6	23	304	38	3300	5500	14300	0.770	59.5	RC-12	27.5	HC-12	HJ-12
TF3B-15A8	117.5	10.6	23	381	40	2500	7240	18355	2.255	134	RC-15	23.5	HC-15	HJ-15
TF3B-15A11	117.5	10.6	23	381	40	2500	7240	18355	2.241	127	RC-15	23.5	HC-15	HJ-15
TF3B-18A11	117.5	10.6	23	450	40	2000	7240	18355	3.744	171	RC-15	23.5	HC-15	HJ-15
TF3B-21A11	170	13	28	530	50	1700	9177	23861	8.893	238	RC-2816	30.5	HC-21	HJ-21
TF3B-21A15	170	13	28	530	50	1700	9177	23861	9.023	235	RC-2816	30.5	HC-21	HJ-21
TF3B-24A11	170	13	28	610	50	1400	9177	23861	18.199	296	RC-2816	30.5	HC-21	HJ-21
TF3B-24A15	170	13	28	610	50	1400	9177	23861	17.376	293	RC-2816	30.5	HC-21	HJ-21

DIMENSION

MODEL	A	B	G H6	D	E	F	C H6	H	J	K	L	M	P		R	S	T	U MAX	V	W	X	Y	A1	M1	t	Ref. Figure
													Max.	Min.												
TF3B-5A4	135	71	96	14	15	63.513	110	82.55	15.5	3xM10	33	4	16	6	10	20	23	M40x1.5	3xM6	45	12	30	52	M6	5	Fig. 1
TF3B-6A5	169	91	116	20	15	82.563	140	104.78	16	6xM10	45	5	26	14	12	19	32	M55x2.0	3xM6	60	16	36	65	M8	5	Fig. 1
TF3B-8A5	210	109	133.35	25	22	82.563	170	104.78	13	6xM12	52	5	37.5	21.5	14	20.5	37	M60x2.0	6xM10	66	16	45	80	M8	5	Fig. 2
TF3B-8A6	210	103	150	25	17	106.375	170	133.35	19	6xM12	52	5	31.5	15.5	14	20.5	37	M60x2.0	3xM6	66	16	45	80	M8	5	Fig. 1
TF3B-10A6	254	120	171.45	30	25	106.375	220	133.35	18	6xM16	75	5	33.5	14.5	16	25	42	M85x2.0	6xM12	94	16	60	102	M10	5	Fig. 2
TF3B-10A8	254	113	190	30	18	139.719	220	171.45	24	6xM16	75	5	26.5	7.5	16	25	42	M85x2.0	6xM8	94	16	60	102	M10	5	Fig. 1
TF3B-12A6	304	129	190	30	25	106.375	220	133.35	25	6xM16	91	6	33	10	21	28	52	M100x2.0	6xM12	108	20	60	100	M10	5	Fig. 2
TF3B-12A8	304	122	190	30	18	139.719	220	171.45	25	6xM16	91	6	26	3	21	28	52	M100x2.0	6xM8	108	20	60	100	M10	5	Fig. 1
TF3B-15A8	381	160	235	43	33	139.719	300	171.45	24	6xM20	117.5	6	40	17	24	39	62	M130x2.0	6xM16	139	20	80	150	M12	5	Fig. 2
TF3B-15A11	381	149	260	43	22	196.869	300	235	28	6xM20	117.5	6	34	11	24	39	62	M130x2.0	3xM10	139	20	80	150	M12	5	Fig. 1
TF3B-18A11	450	149	260	43	22	196.869	300	235	28	6xM20	117.5	6	33	10	24	39	62	M130x2.0	3xM10	139	20	80	150	M12	5	Fig. 1
TF3B-21A11	530	183	330.2	60	41	196.869	380	235	30	6xM22	170	6	57	29	25	40	65	M180x3.0	6xM12	207	20	100	200	M12	5	Fig. 2
TF3B-21A15	530	169	330.2	60	27	285.75	380	330.2	30	6xM22	170	6	43	15	25	40	65	M180x3.0	6xM12	207	20	100	200	M12	5	Fig. 1
TF3B-24A11	610	183	330.2	60	41	196.869	380	235	30	6xM22	170	6	57	29	25	40	65	M180x3.0	6xM12	207	20	100	200	M12	5	Fig. 2
TF3B-24A15	610	169	330.2	60	27	285.75	380	330.2	30	6xM22	170	6	43	15	25	40	65	M180x3.0	6xM12	207	20	100	200	M12	5	Fig. 1

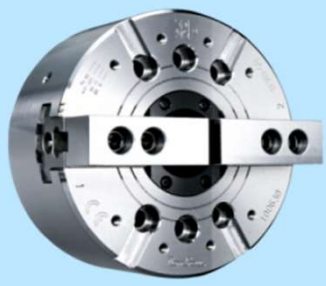

TF2BA- SERIES



兩爪高速中空油壓夾頭(包含連接板)

2-JAW HIGH SPEED WEDGE TYPE THROUGH HOLE POWER CHUCK
(with ADAPTOR)

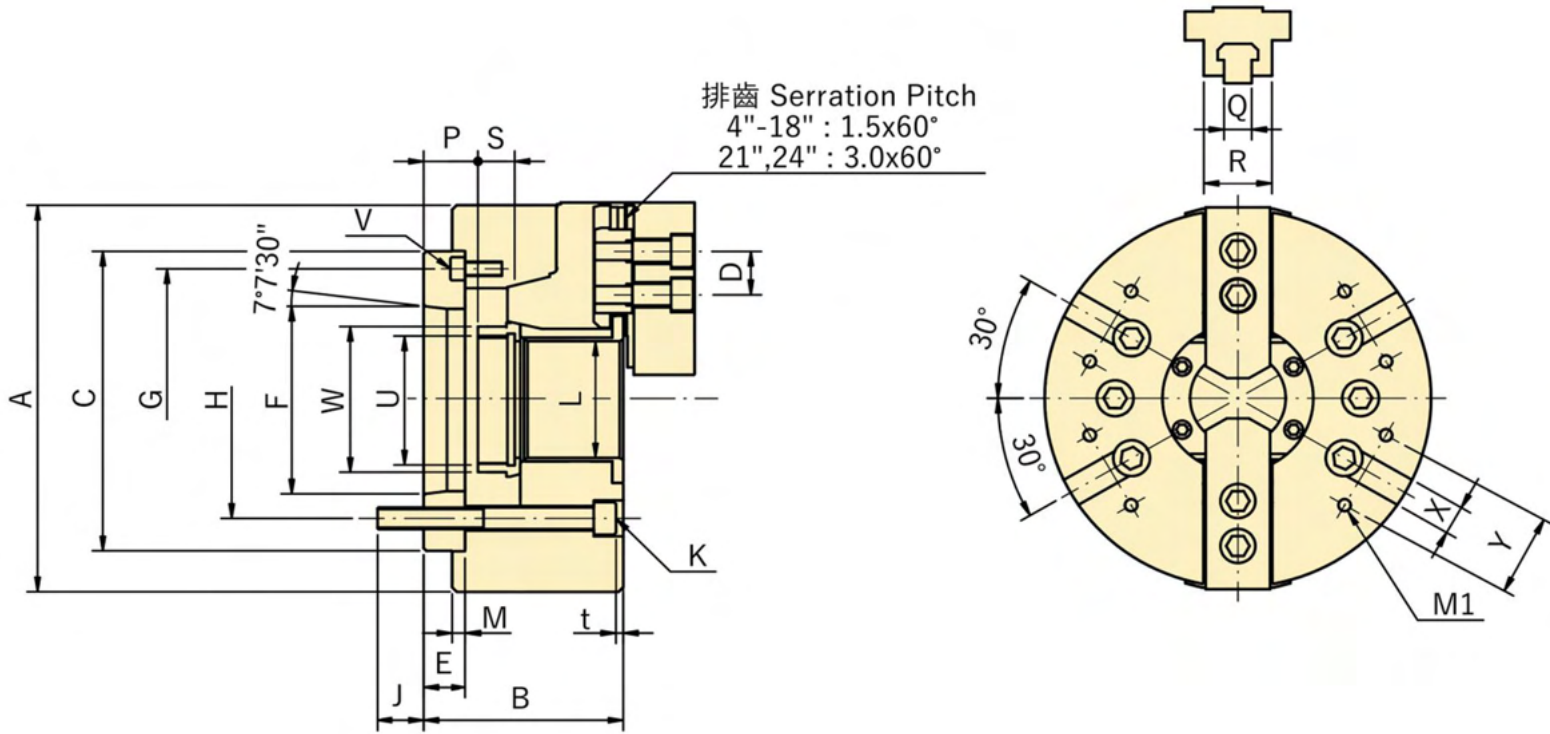

SPECIFICATION

MODEL	爪行程 (直徑) Jaw Stroke (Dia.) (mm)	柱塞行程 Plunger Stroke (mm)	把握徑 Clamping Dia.		最高轉數 Max. Rotation Speed (r.p.m.)	最大拉桿推力 Max. Draw Bar Pull Force (Kgf)	把握力 Max. Clamping Force (Kgf)	慣性矩 Moment of Inertia (kg·m ²)	重量 Weight (KG)	搭配油壓缸 Matching Hydraulic Cylinder	最高使用壓力 Max. Pressure of Hydraulic Cylinder (kgf/cm ²)
			Max. (mm)	Min. (mm)							
TF2B-4	5.4	10	110	10	8000	948	1935	0.006	3.8	RC-4	23
TF2B-5A4	5.4	10	135	10	7000	1158	2399	0.017	6.7	RC-5	16
TF2B-6A5	5.5	12	165	10	6000	1450	3800	0.056	14	RC-6	19
TF2B-8A6	7.4	16	210	12	4900	2250	5600	0.165	23.5	RC-8	17.5
TF2B-10A8	8.8	19	210	16	4200	2850	7400	0.308	36.8	RC-10	18.5
TF2B-12A8	10.6	23	304	38	3300	3667	9600	0.7	58.7	RC-12	18.5
TF2B-15A11	10.6	23	381	40	2500	4793	12236	2.3	125	RC-15	15.3

DIMENSION

MODEL	A	B	G H6	D	E	F	C H6	H	J	K	L	M	P		R	S	T	U MAX	V	W	X	Y	A1	M1	t
													Max.	Min.											
TF2B-4	110	59	-	14	-	-	85	70.6	16	4xM10	26	4	3.5	-6.5	23	17.5	23	M32x1.5	-	38	-	-	-	-	-
TF2B-5A4	135	71	96	14	15	63.513	110	82.55	15.5	4xM10	33	4	16	6	10	20	23	M40x1.5	3xM6	45	12	30	52	M6	5
TF2B-6A5	169	91	116	20	15	82.563	140	104.78	16	6xM10	45	5	26	14	12	19	32	M55x2.0	3xM6	60	16	36	65	M8	5
TF2B-8A6	210	103	150	25	17	106.375	170	133.35	19	6xM12	52	5	31.5	15.5	14	20.5	37	M60x2.0	3xM6	66	16	45	80	M8	5
TF2B-10A8	254	113	190	30	18	139.719	220	171.45	24	6xM16	75	5	26.5	7.5	16	25	42	M85x2.0	6xM8	94	16	60	102	M10	5
TF2B-12A8	304	122	190	30	18	139.719	220	171.45	25	6xM16	91	6	26	3	21	28	52	M100x2.0	6xM8	108	20	60	100	M10	5
TF2B-15A11	381	149	260	43	22	196.869	300	235	28	6xM20	117.5	6	34	11	24	39	62	M130x2.0	3xM10	139	20	80	150	M12	5

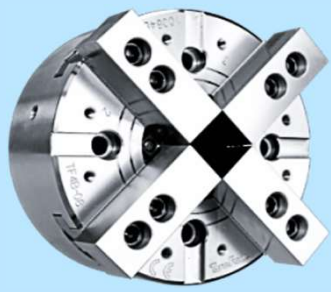

TF4BA- SERIES



四爪高速中空油壓夾頭(包含連接板)

4-JAW HIGH SPEED WEDGE TYPE THROUGH HOLE POWER CHUCK
(with ADAPTOR)

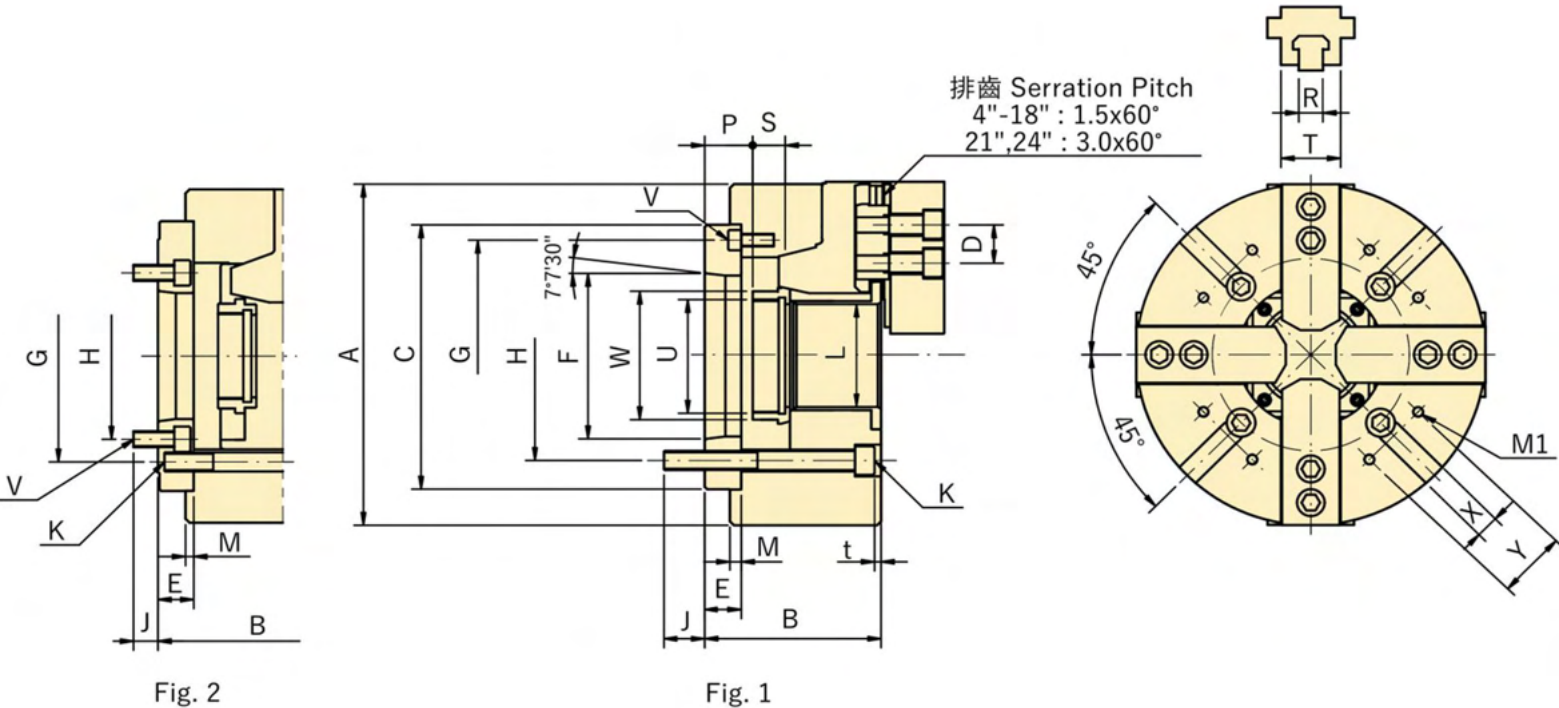

SPECIFICATION

MODEL	爪行程 (直徑) Jaw Stroke (Dia.) (mm)	柱塞行程 Plunger Stroke (mm)	把握徑 Clamping Dia.		最高轉數 Max. Rotation Speed (r.p.m.)	最大拉桿推力 Max. Draw Bar Pull Force (Kgf)	把握力 Max. Clamping Force (Kgf)	慣性矩 Moment of Inertia (kg·m ²)	重量 Weight (KG)	搭配油壓缸 Matching Hydraulic Cylinder	最高使用壓力 Max. Pressure of Hydraulic Cylinder (kgf/cm ²)
			Max. (mm)	Min. (mm)							
TF4B-6A5	5.5	12	165	10	4500	1450	3800	0.056	14	RC-6	19
TF4B-8A5	7.4	16	210	12	3600	2250	5600	0.172	24.2	RC-8	17.5
TF4B-8A6	7.4	16	210	12	3600	2250	5600	0.165	23.5	RC-8	17.5
TF4B-10A6	8.8	19	210	16	3200	2850	7400	0.356	37.8	RC-10	18.5
TF4B-10A8	8.8	19	210	16	3200	2850	7400	0.308	36.8	RC-10	18.5
TF4B-12A8	10.6	23	304	38	2700	3667	9600	0.7	58.7	RC-12	18.5
TF4B-15A8	10.6	23	381	40	1900	4793	12236	2.41	130	RC-15	15.3
TF4B-15A11	10.6	23	381	40	1900	4793	12236	2.38	125	RC-15	15.3

DIMENSION

MODEL	A	B	G	D	E	F	C	H	J	K	L	M	P		R	S	T	U _{MAX}	V	W	X	Y	A1	M1	t	Ref.
													Max.	Min.												
TF4B-6A5	169	91	116	20	15	82.563	140	104.78	16	4xM10	45	5	26	14	12	19	32	M55x2.0	4xM6	60	16	36	65	M8	5	Fig. 1
TF4B-8A5	210	109	133.35	25	23	82.563	170	104.78	13	4xM12	52	5	37.5	22.5	14	20.5	37	M60x2.0	4xM6	66	16	45	80	M8	5	Fig. 2
TF4B-8A6	210	103	150	25	17	106.375	170	133.35	18	4xM12	52	5	31.5	15.5	14	20.5	37	M60x2.0	4xM6	66	16	45	80	M8	5	Fig. 1
TF4B-10A6	254	120	171.45	30	25	106.375	220	133.35	18	4xM16	75	5	33.5	14.5	16	25	42	M85x2.0	4xM12	94	16	60	102	M10	5	Fig. 2
TF4B-10A8	254	113	190	30	18	139.719	220	171.45	24	4xM16	75	5	26.5	7.5	16	25	42	M85x2.0	4xM8	94	16	60	102	M10	5	Fig. 1
TF4B-12A8	304	122	190	30	18	139.719	220	171.45	25	4xM16	91	6	26	3	21	28	52	M100x2.0	4xM8	108	20	60	100	M10	5	Fig. 1
TF4B-15A8	381	160	235	43	33	139.719	300	171.45	24	4xM20	117.5	6	40	17	24	39	62	M130x2.0	4xM10	139	20	80	150	M12	5	Fig. 2
TF4B-15A11	381	163	260	43	22	196.869	300	235	28	4xM20	117.5	6	29	11	24	39	62	M130x2.0	4xM10	139	20	80	150	M12	5	Fig. 1



TF3CA-/TF3XA- SERIES

三爪高速中空油壓夾頭(大孔徑)(包含連接板)

3-JAW HIGH SPEED WEDGE TYPE THROUGH HOLE POWER CHUCK
(with ADAPTOR) (BIG BORE)

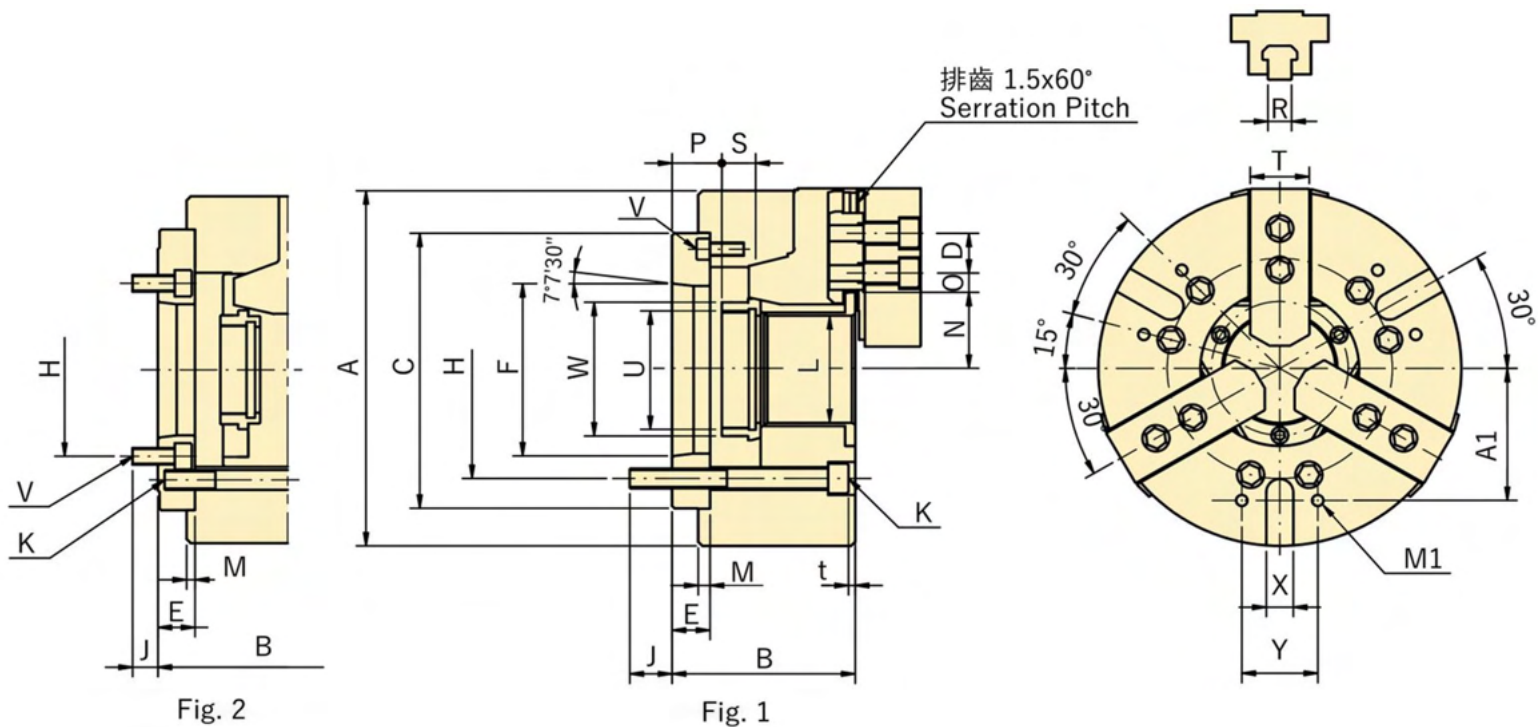

SPECIFICATION

MODEL	通孔徑 Through Hole Dia. (mm)	爪行程(直徑) Jaw Stroke (Dia.) (mm)	柱塞行程 Plunger Stroke (mm)	最高轉數 Max. Rotation Speed (r.p.m.)	最大拉桿推力 Max. Draw Bar Pull Force (kgf)	把握力 Max. Clamping Force (kgf)	最高使用壓力 Max. Pressure of Hydraulic Cylinder (kgf/cm ²)	重量 Weight (KG)	搭配油壓缸 Matching Hydraulic Cylinder	搭配生爪 Matching Soft Jaw	搭配硬爪 Matching Hard Jaw
TF3C-6A5	52	5.5	12	6000	2200	5700	18	14.2	RCS-8	HC06	HJ06
TF3C-8A6	66	7.4	17	5000	3400	8700	18	24.5	RCS-10S	HC08	HJ08
TF3X-10A8	78	8.8	19	4200	4300	11000	27.5	37.4	RC-10X	HC10	HJ10
TF3X-12A8	110	10.6	23	3300	5500	14300	19.5	61	RC-15	HC12	HJ12
TF3X-12A11	110	10.6	23	3300	5500	14300	19.5	61	RC-15	HC12	HJ12

DIMENSION

DIM.	A	B	C H6	D	E	F	H	J	K	L	M	N		O		P		R	S	T	U MAX	V	W	X	Y	A1	M1	t	Ref.
												Max.	min.	Max.	min.	Max.	min.												
TF3C-6A5	175	75	140	20	30	82.563	104.78	16	6-M10	52	5	32	29.25	24	7.5	25	12.5	12	19	32	M60x2	-	66	16	36	65	M8	5	Fig. 1
TF3C-8A6	215	108.5	170	25	22.5	106.36	133.4	16	6-M12	66	7	46	42	25.5	10.5	12.5	-4.5	14	25	37	M74x2	-	82	16	45	80	M8	5	Fig. 1
TF3X-10A8	254	113	220	30	18	139.719	171.45	20	6-M16	78	5	51	46.6	34.5	12	26.5	7.5	16	25	42	M87x2	-	96	16	60	102	M10	5	Fig. 1
TF3X-12A8	318	137	300	30	33	139.719	171.45	20	6-M20	110	6	68	63	53.5	19	37	14	21	28	52	M115x2	6-M6	127	20	60	140	M10	5	Fig. 2
TF3X-12A11	318	126	300	30	22	196.8	235	20	6-M20	110	6	68	63	53.5	19	26	3	21	28	52	M115x2	-	127	20	60	140	M10	5	Fig. 1



TF2CA-/TF2XA- SERIES

兩爪高速中空油壓夾頭(大孔徑)(包含連接板)
 2-JAW HIGH SPEED WEDGE TYPE THROUGH HOLE POWER CHUCK
 (with ADAPTOR) (BIG BORE)

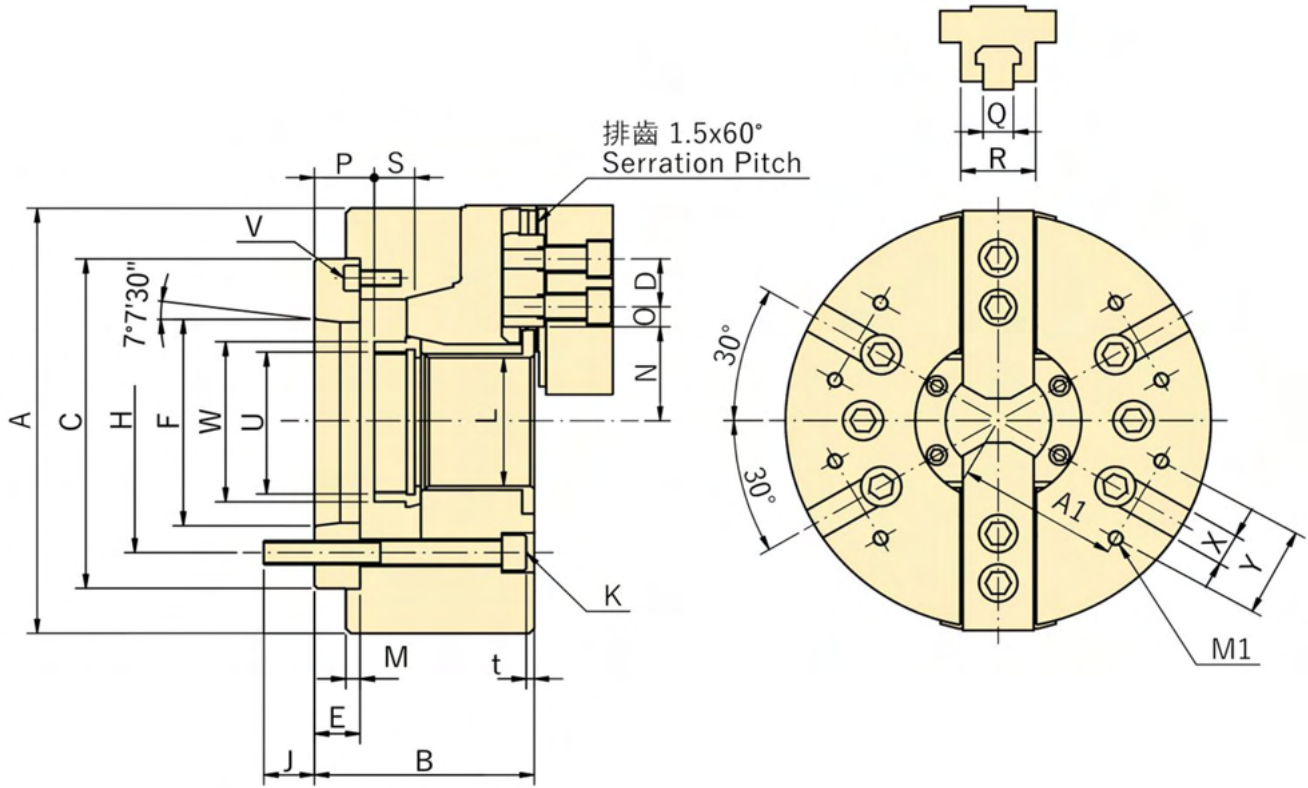

SPECIFICATION

MODEL	通孔徑 Through Hole Dia. (mm)	爪行程(直徑) Jaw Stroke (Dia.) (mm)	柱塞行程 Plunger Stroke (mm)	最高轉數 Max. Rotation Speed (r.p.m.)	最大拉桿推力 Max. Draw Bar Pull Force (kgf)	把握力 Max. Clamping Force (kgf)	最高使用壓力 Max. Pressure of Hydraulic Cylinder (kgf/cm ²)	重量 Weight (KG)	搭配油壓缸 Matching Hydraulic Cylinder	搭配生爪 Matching Soft Jaw	搭配硬爪 Matching Hard Jaw
TF2C-6A5	52	5.5	12	6000	1500	3900	18	13.2	RCS-8	HC06	HJ06
TF2C-8A6	66	7.4	17	4600	2400	6000	18	23.1	RCS-10S	HC08	HJ08
TF2X-10A8	78	8.8	19	4200	3000	7500	18.5	36.2	RCS-10X	HC10	HJ10

DIMENSION

MODEL	A	B	C	H ₆	D	E	F	H	J	K	L	M	N		O		P		R	S	T	U _{MAX}	V	W	X	Y	A1	M1	t
													Max.	min.	Max.	min.	Max.	min.											
TF2C-6A5	175	75	140	20	30	82.5	63	104.78	16	6-M10	52	5	32	29.25	24	7.5	25	12.5	12	19	32	M60x2	-	66	16	36	65	M8	5
TF2C-8A6	215	108.5	170	25	22.5	106.36	133.4	133.4	16	6-M12	66	7	46	42	25.5	10.5	12.5	-4.5	14	25	37	M74x2	-	82	16	45	80	M8	5
TF2X-10A8	254	113	220	30	18	139.719	171.45	171.45	20	6-M16	78	5	51	46.6	34.5	12	26.5	7.5	16	25	42	M87x2	-	96	16	60	102	M10	5

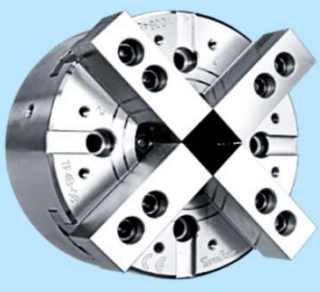

TF4CA-/TF4XA- SERIES Tomfau

四爪高速中空油壓夾頭(大孔徑)(包含連接板)
 4-JAW HIGH SPEED WEDGE TYPE THROUGH HOLE POWER CHUCK
 (with ADAPTOR) (BIG BORE)

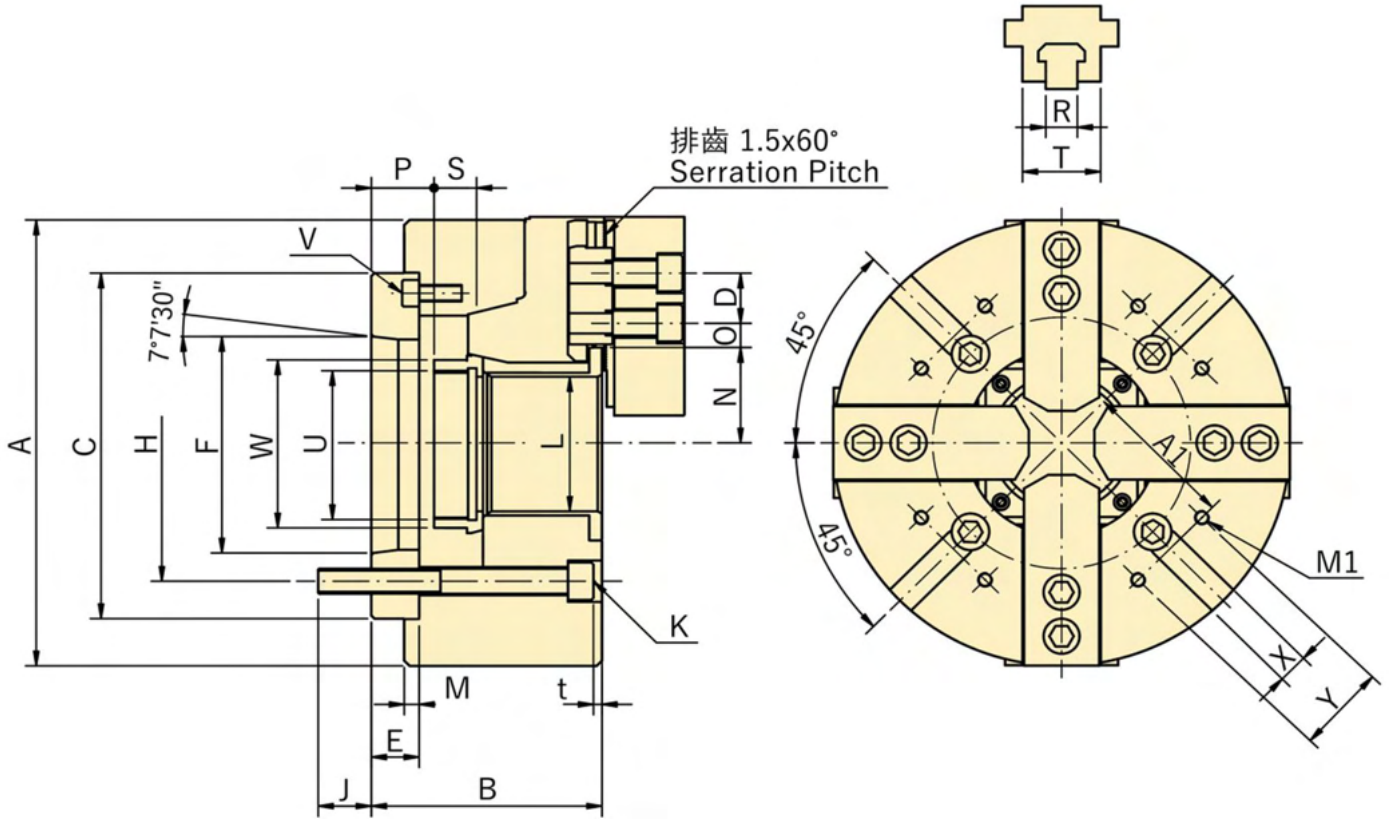

SPECIFICATION

MODEL	通孔徑 Through Hole Dia. (mm)	爪行程(直徑) Jaw Stroke (Dia.) (mm)	柱塞行程 Plunger Stroke (mm)	最高轉數 Max. Rotation Speed (r.p.m.)	最大拉桿推力 Max. Draw Bar Pull Force (kgf)	把握力 Max. Clamping Force (kgf)	最高使用壓力 Max. Pressure of Hydraulic Cylinder (kg/cm ²)	重量 Weight (KG)	搭配油壓缸 Matching Hydraulic Cylinder	搭配生爪 Matching Soft Jaw	搭配硬爪 Matching Hard Jaw
TF4C-6A5	52	5.5	12	4500	2500	6000	28	13.2	RCS-8	HC06	HJ06
TF4C-8A6	66	7.4	17	3600	3600	9000	27	23.1	RCS-10S	HC08	HJ08
TF4X-10A8	78	8.8	19	3200	4500	11250	27.5	36.2	RCS-10X	HC10	HJ10

DIMENSION

MODEL	A	B	C	H ₆	D	E	F	H	J	K	L	M	N		O		P		R	S	T	U	MAX	V	W	X	Y	A1	M1	t
													Max.	min.	Max.	min.	Max.	min.												
TF4C-6A5	175	75	140	20	30	82.563	104.78	16	6-M10	52	5	32	29.25	24	7.5	25	12.5	12	19	32	M60x2	-	66	16	36	65	M8	5		
TF4C-8A6	215	108.5	170	25	22.5	106.36	133.4	16	6-M12	66	7	46	42	25.5	10.5	12.5	-4.5	14	25	37	M74x2	-	82	16	45	80	M8	5		
TF4X-10A8	254	113	220	30	18	139.719	171.45	20	6-M16	78	5	51	46.6	34.5	12	26.5	7.5	16	25	42	M87x2	-	96	16	60	102	M10	5		